

ISSUED 16-Jan-09	OUTLINE DIMENSIONS SHEET	MODEL BEML
REVISED		ALUMINIUM FRAME 1-PHASE CAPACITOR START & RUN MOTORS FRAME NOS. 63 ~ 112M

Totally Enclosed Fan Cooled Type, Squirrel Cage Rotor

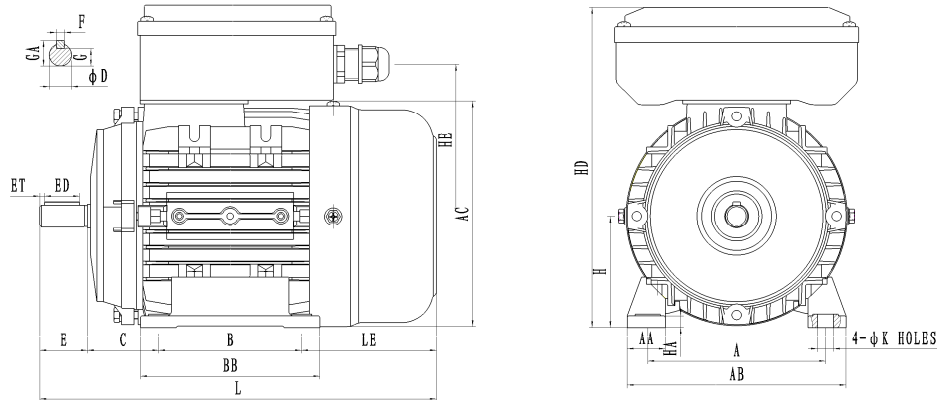

Dimension in mm

ML B3

Output (HP)		FRAME SIZE	FIG. No.	A	AA	AB	AC	B	BB	C	H	HA	HD	HE	K
2P	4P														
0.25 0.34	0.16 0.25	D63	1	100	22	122	130	80	108	40	63	8	185	86	7
0.5 0.75	0.34 0.5	D71		112	24	138	145	90	113	45	71	10	202	96	7
1 1.5	0.75 1	D80		125	27	159	158	100	122	50	80	10	224	102	10
2	1.5	D90S		140	35	175	177	100	155	56	90	14	245	112	10
3	2	D90L		140	35	175	177	125	155	56	90	14	245	112	10
4	3 4	D100L		160	43	205	203	140	176	63	100	15	263	123	12
5	5	D112M		190	45	222	226	140	180	70	112	15	291	135	12

FRAME SIZE	FIG. No.	L	LE	SHAFT EXTENSION							BEARING		APPROX. WEIGHT KGS.
				D	E	ED	ET	F	G	GA	DRIVE END	OPPOSITE DRIVE END	
D63	1	243	100	11	23	16	3	4	8.5	12.5	6201ZZ	6201ZZ	5.3
D71		250	85	14	30	22	3	5	11	16	6202ZZ	6202ZZ	7
D80		301	113	19	40	32	3	6	15.5	21.5	6204ZZ	6203ZZ	11.5
D90S		334	126	24	50	40	5	8	20	27	6205ZZ	6203ZZ	15
D90L		360	128	24	50	40	5	8	20	27	6205ZZ	6203ZZ	19
D100L		401	138	28	60	50	5	8	24	31	6206ZZ	6205ZZ	23
D112M		422	152	28	60	50	5	8	24	31	6306ZZ	6206ZZ	30

- Note :**
1. Tolerance of shaft end diameter D : Under $\phi 19 \sim \phi 28 : j6, \phi 38 : k6$.
 2. Tolerance of shaft center high H : $+0, -0.5$.

ISSUED 16-Jan-09	OUTLINE DIMENSIONS SHEET	MODEL BEML
REVISED		ALUMINIUM FRAME 1-PHASE CAPACITOR START & RUN MOTORS FRAME NOS. 63 ~ 112M

Totally Enclosed Fan Cooled Type, Squirrel Cage Rotor

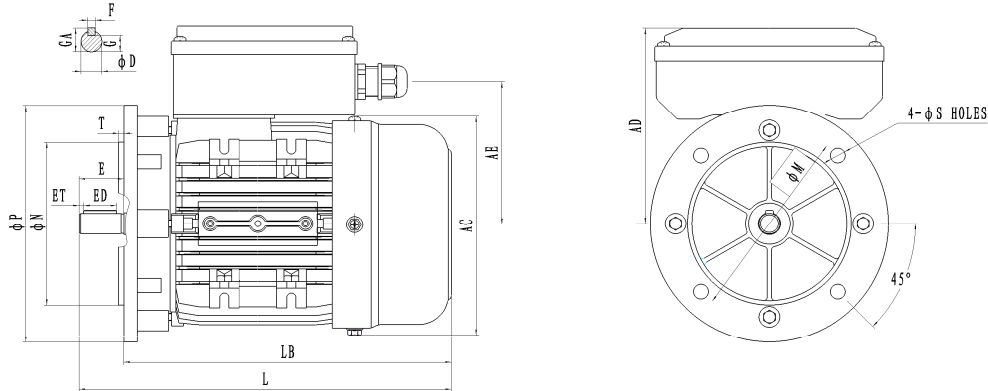

Dimension in mm

ML B5

Output (HP)		FRAME SIZE	FIG. No.	AC	AD	AE	L	LA	LB	M	N	P	S	T
2P	4P													
0.25 0.34	0.16 0.25	D63	1	130	122	86	243	9	220	115	95	140	10	3
0.5 0.75	0.34 0.5	D71		145	132	96	252	9	220	130	110	160	10	3.5
1 1.5	0.75 1	D80		158	144	102	301	10	261	165	130	200	12	3.5
2	1.5	D90S		177	155	112	334	12	284	165	130	200	12	3.5
3	2	D90L		177	155	112	360	12	310	165	130	200	12	3.5
4	3 4	D100L		203	165	123	401	14	341	215	180	250	15	4.0
5	5	D112M		226	179	135	422	14	362	215	180	250	15	4.0

FRAME SIZE	FIG. No.	SHAFT EXTENSION							BEARING		APPROX. WEIGHT KGS.
		D	E	ED	ET	F	G	GA	DRIVE END	OPPOSITE DRIVE END	
D63	1	11	23	16	3	4	8.5	12.5	6201ZZ	6201ZZ	5.3
D71		14	30	22	3	5	11	16	6202ZZ	6202ZZ	7.5
D80		19	40	32	3	6	15.5	21.5	6204ZZ	6203ZZ	12
D90S		24	50	40	5	8	20	27	6205ZZ	6203ZZ	15.5
D90L		24	50	40	5	8	20	27	6205ZZ	6203ZZ	20
D100L		28	60	50	5	8	24	31	6206ZZ	6205ZZ	24.5
D112M		28	60	50	5	8	24	31	6306ZZ	6206ZZ	30

- Note :**
1. Tolerance of shaft end diameter D : Under $\phi 19 \sim \phi 28$: j6, $\phi 38$: k6.
 2. Tolerance of shaft center high H : +0, -0.5 .